

traxon

Mounting Guide

BEFORE MOUNTING, PLEASE READ THE USER MANUAL FOR CABLING AND CONNECTION DETAILS.

DOT XL-3

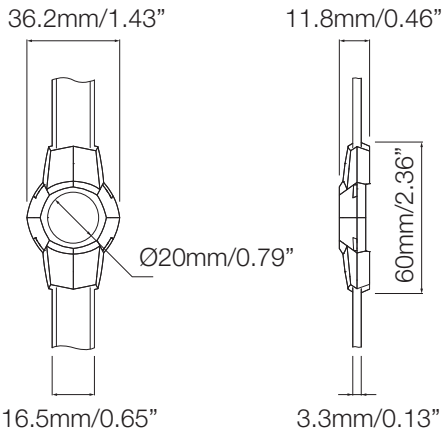

Optional Parts

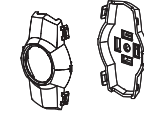

Dot Clip
DO.AC.0002400



Diffuser Dome
DO.AC.0002500

15.5mm/0.61"

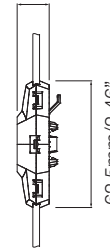

With optional clip assembly

27mm/1.06"

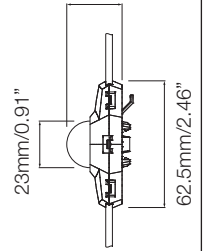

With optional diffuser dome and clip assembly

Dot clip assembly

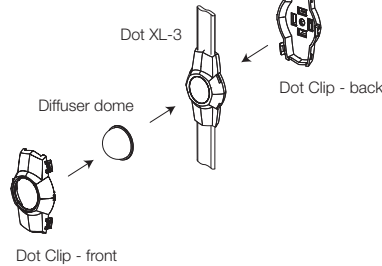

Mounting the Dot XL

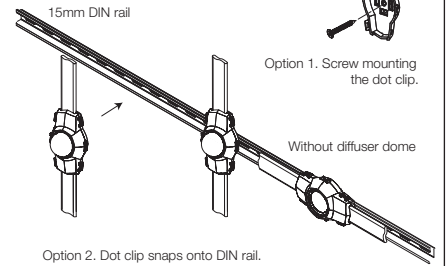

LED Engine and Pixel Distributor

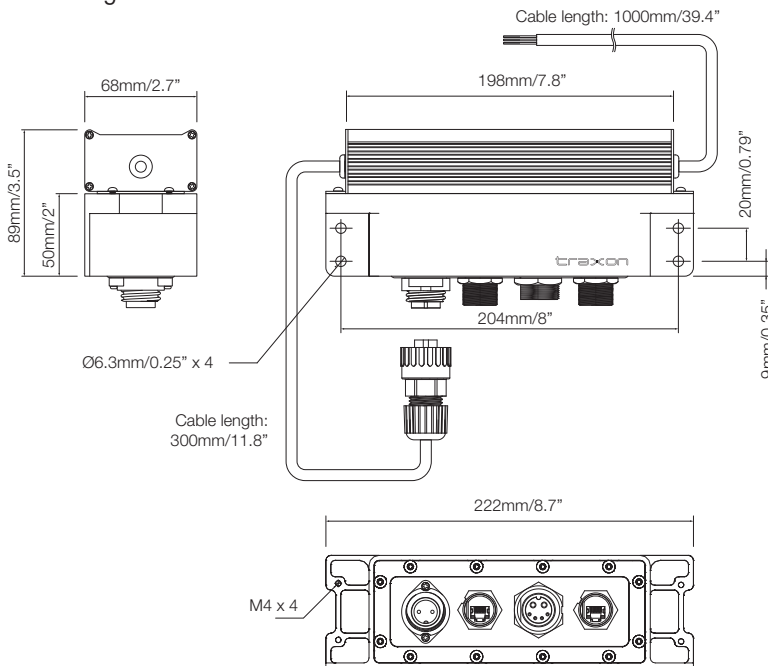

CAUTION: Always use the housing unit for mounting. Handle string with care. Improper handling of lead cable and string will cause damage.

Mounting the LED Engine and Pixel Distributor

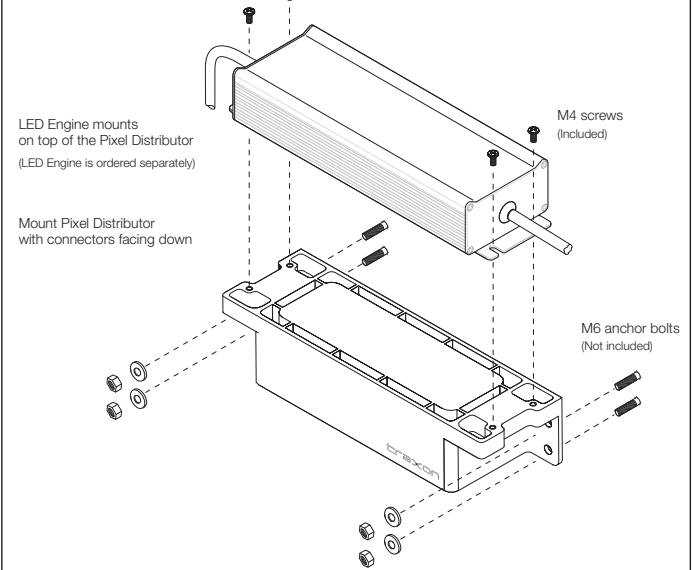

Terminating the Dot XL cable and Sealing with End Cap (End cap not included)

