

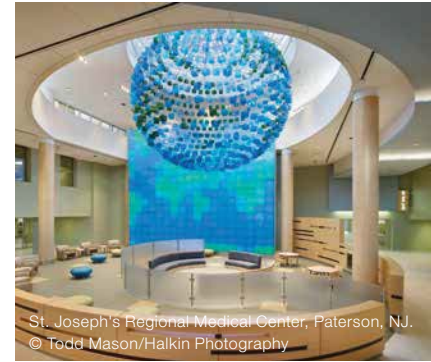

Nemours Children's Hospital, Orlando, FL
Architect of Record/Design Architect: Stanley Beaman & Sears
Associate Architect: Perkins + Will/Photography © 2012 Jonathan Hillyer



St. Joseph's Regional Medical Center, Paterson, NJ.
© Todd Mason/Halkin Photography



Brookfield Place, Toronto, Canada
© Scott Norsworthy

Light is our passion

OSRAM Lighting Solutions

traxone:cue
AN OSRAM BUSINESS

OSRAM

Redefining the



skyline

A nighttime photograph of a city skyline. In the foreground, a large, ornate classical building is illuminated with warm yellow lights. To the left, a tall, curved building is lit with horizontal red lines. In the center, another tall, curved building is lit with horizontal white lines. A large fountain with a tall, thin water column is in the lower left. In the lower right, a large, glowing blue sphere is visible. People are walking in the foreground, and a car is visible in the distance.

Traxon Technologies

Traxon Technologies, an OSRAM business, together with its control brand, e:cue is a global leader in solid state lighting and control systems providing complete, sustainable and intelligent lighting solutions. Working with our extensive partner network, Traxon transforms creative visions into unforgettable lighting experiences, elevating architectural, sports & leisure, hospitality, office and retail environments around the world. Traxon's innovative, integrated control, software, product and project portfolios have won many awards and accolades for their pioneering technologies and dynamic solutions, including LFI Innovation, iF Design, Red Dot Design, DDC, POPAI, MELDA, PLDR and Architectural SSL PIA. For more information, please visit www.traxontechnologies.com

About OSRAM Lighting Solutions

OSRAM Lighting Solutions sets new standards regarding innovative, custom-designed and performance-driven professional lighting solutions for the complete spectrum of light, creating added value for customers around the world. Our passion, knowledge and spirit about all aspects of light leads to breathtaking, innovative and state-of-the-art professional lighting projects for a sustainable and energy-efficient future.

With our four flagship brands OSRAM, Traxon Technologies, SYLVANIA Lighting Solutions, Siteco and our global expert network we provide intelligent, flexible and future-proof solutions and services exactly where you need them – on location. For more information, please visit www.lightingsolutions.osram.com/northamerica.



COLOR BAR
BY KENDRA SCOTT

Retail

Kendra Scott Retail Stores, Quarry Village, San Antonio, TX © Kendra Scott



Office



Sports & Leisure

National Stadium, Warsaw, Poland © Florian Licht, Licht und Soehne





BASF, Florham Park, NJ © David Joseph



210 Baronne, New Orleans, LA © Ruby Rubenstahl

Architecture

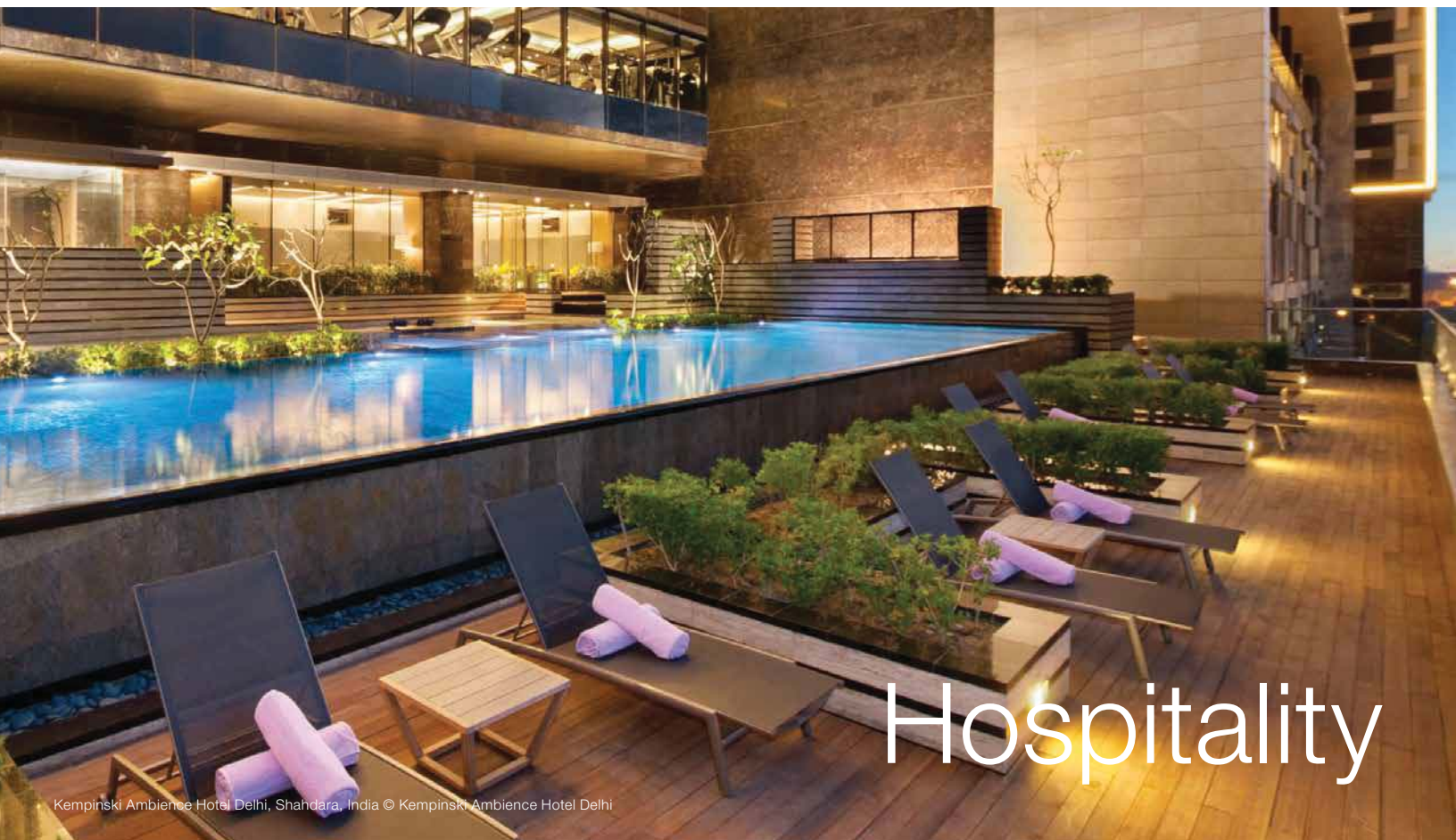

Hospitality

Kempinski Ambience Hotel Delhi, Shandara, India © Kempinski Ambience Hotel Delhi

Featured Products:



Cove Light AC HE

- Extremely efficient
- Integral 120/220-240V driver
- CCT output: 2700K, 3000K, 3500K or 4000K
- 120°x120° beam spread
- 180° locking rotation
- 185-210 lm/ft output
- 60-68 lm/ft efficacy
- 3.1W/ft input power



Cove Light AC Dim

- Daisy-chain topology, simple cabling and connection
- Integral 120/220-240/277V driver
- CCT output: 2700K, 3000K, 3500K, or 4000K
- Phase cut 5% dimming
- 135°x135° beam spread
- 180° locking rotation
- 339 - 380 lm/ft output
- 48-55 lm/W efficacy
- 7W/ft input power



Cove Light AC HO/HO Graze

- High output and efficacy
- Integral to 120/277V driver
- CCT output: 2700K, 3000K, 3500K, or 4000K
- RGB Graze
- Phase cut 5% dimming
- 60°x30°, 50°x10° beam spreads
- 180° adjustable rotation
- 281 lm/ft output
- 23 lm/W efficacy
- 12.5W/ft input power



Cove Light AC HO RGBW

- Seamless full spectrum internal color mixing
- Integral to 120/277V driver
- 4 channel RGB (W: 3000K), DMX512 controllable
- 120°x120° beam spread
- 180° adjustable rotation
- 310 lm/ft output
- 31 lm/W efficacy
- 11W/ft input power



BASF, Florham Park, NJ © David Joseph



Washer Allegro AC XB

- Integral 120/220-240/277V driver
- RGB or Dynamic White (2700K- 6500K), DMX512 controllable
- 3000K and 4000K: phase cut 5% dimming
- 7°, 20°, 30°, 40° beam spreads
- Pan and tilt locking rotation
- RGB: 1,340 lm output, 26 lm/W efficacy; 52W input power
- 3000K: 2,631 lm output; 67 lm/W efficacy; 44W input power
- 4000K: 2,918 lm output; 74 lm/W efficacy; 44W input power
- Dynamic White: 2,526 lm output, 49 lm/W efficacy, 52W input power
- IP66 rated, suitable for coastal environments



Nano Liner Allegro AC XB

- Integral 120/220-240/277V driver
- 40°, 50°x10° beam spreads
- 180° locking rotation
- RGB or Dynamic White (2700K - 6500K), DMX 512 controllable
- 3000K and 4000K: phase cut 5% dimming
- RGB: 300 lm/ft output; 25 lm/W efficacy; 12.4W/ft input power
- 3000K: 648.45 lm/ft; 65 lm/W efficacy; 11W/ft input power
- 4000K: 720.78 lm/ft; 73.32 lm/W efficacy; 11W/ft input power
- Dynamic White: 529 lm/ft output; 40 lm/W efficacy; 12.4W/ft input power
- IP66 rated, suitable for coastal environments
- Available in 1' and 4' lengths



Liner Quattro AC XB RGBW, Dynamic White

- High output with superior in-fixture color mixing
- Integral Universal 100-277V driver
- Available beam patterns: 13°, 30°x15°, 75°x40°, 60°
- 1494 lm output; 34 lm/W efficacy; 46W input power (2' fixture), 2922 lm output; 34 lm/W efficacy; 85W input power (4' fixture)
- RGBW (W:4000K) and Dynamic White
- IP66 outdoor-rated
- Built-in RDM circuitry for extensive control and monitoring of the entire installation
- Available in 2' and 4' lengths



Media Tube® HO RGBW

- High output with superior color
- High efficacy of 41 lm/W Direct View
- High efficacy of 33 lm/W Diffused View
- 4.6W per foot
- Available beam patterns: 110° (Direct View), 175° (Diffused View)
- RGBW (W:6500K)
- Optional algorithms enable auto control of RGBW, 4 channel fixtures, w/ 3-channel RGB values
- IP66 outdoor-rated
- DMX and e:pix control capable
- Available in 12", 24", 36" 48" and 60" lengths
- Remote 120-277V driver

Please visit www.traxontechnologies.com for more solutions.



Traxon Technologies
200 Ballardvale Street
Wilmington, MA 01887 USA
Phone 1-978-570-3000
www.traxontechnologies.com

OSRAM and TRAXON are registered trademarks.
All other trademarks are those of their respective owners.
Specifications subject to change without notice.

© 2016 OSRAM

TRAX-OLS-BROCH 7-16

OSRAM